

CONCORDE

A cargo-carrying version of Concorde was proposed for Federal Express, though never built.
This model shows how it might have appeared in FedEx livery.

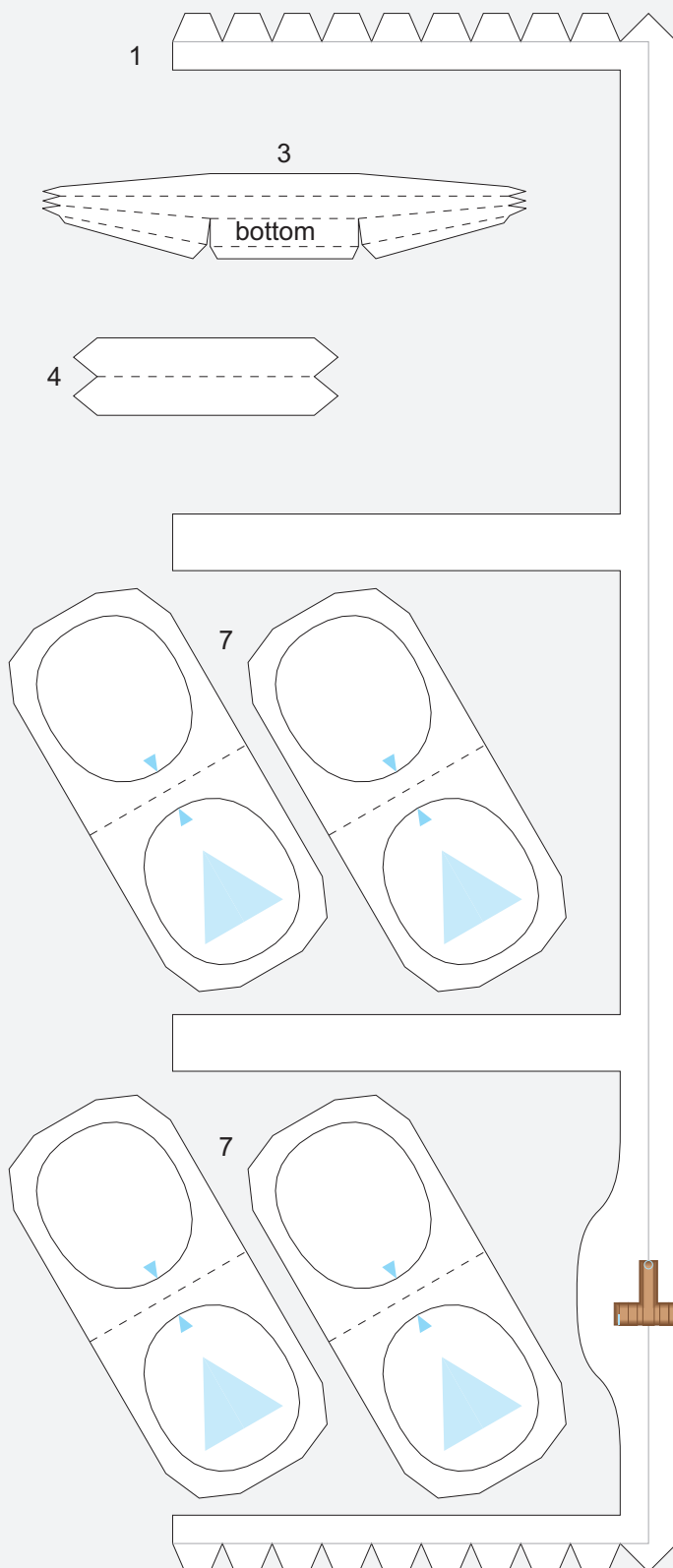

2
Open triangular holes (2 places) and slots (2 places)

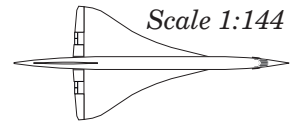
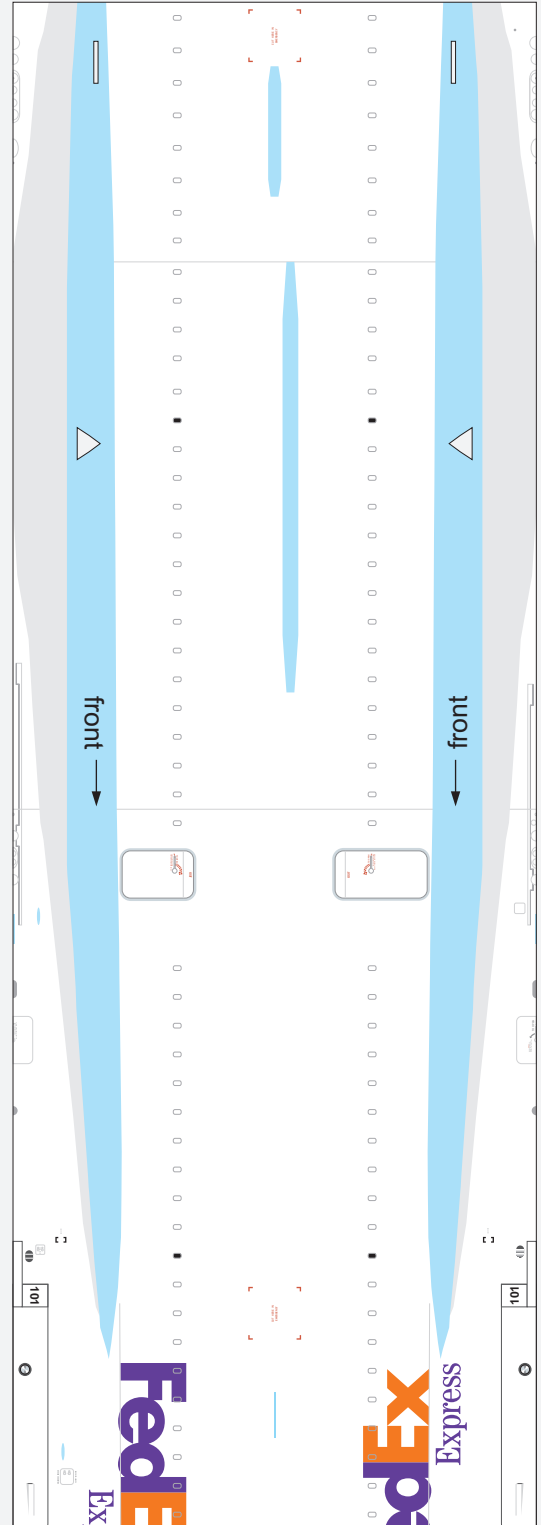

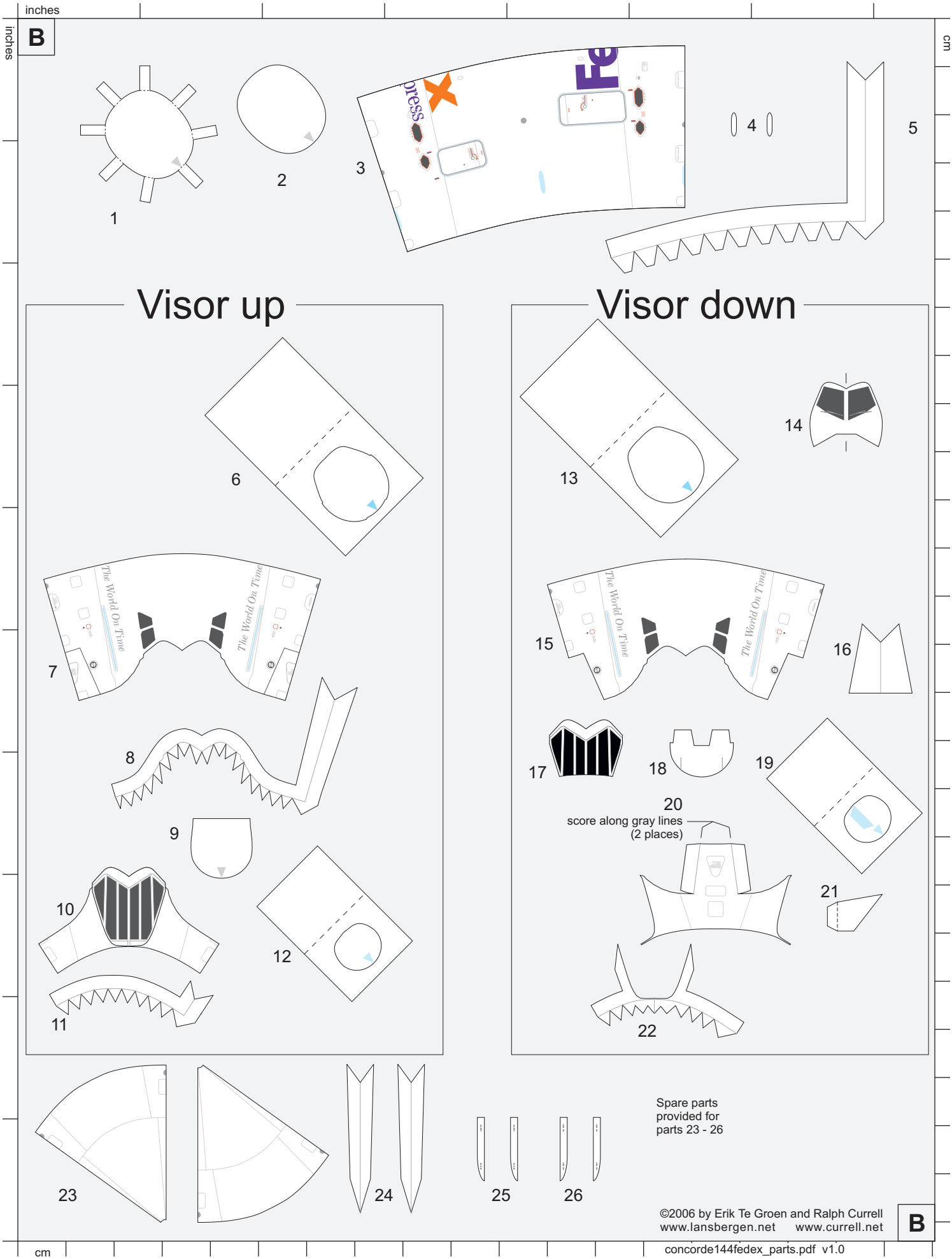

Visor up

Visor down

Spare parts
provided for
parts 23 - 26

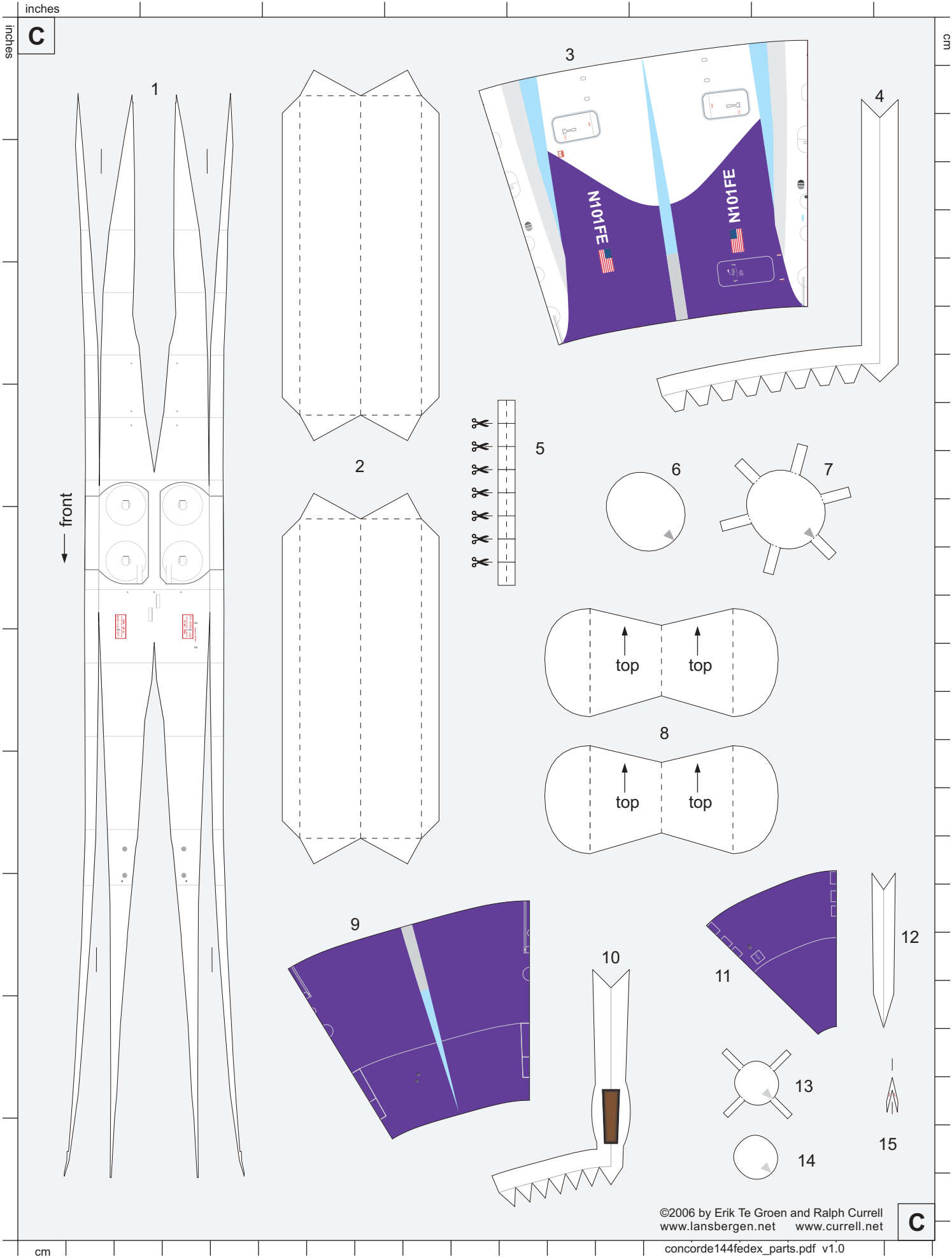

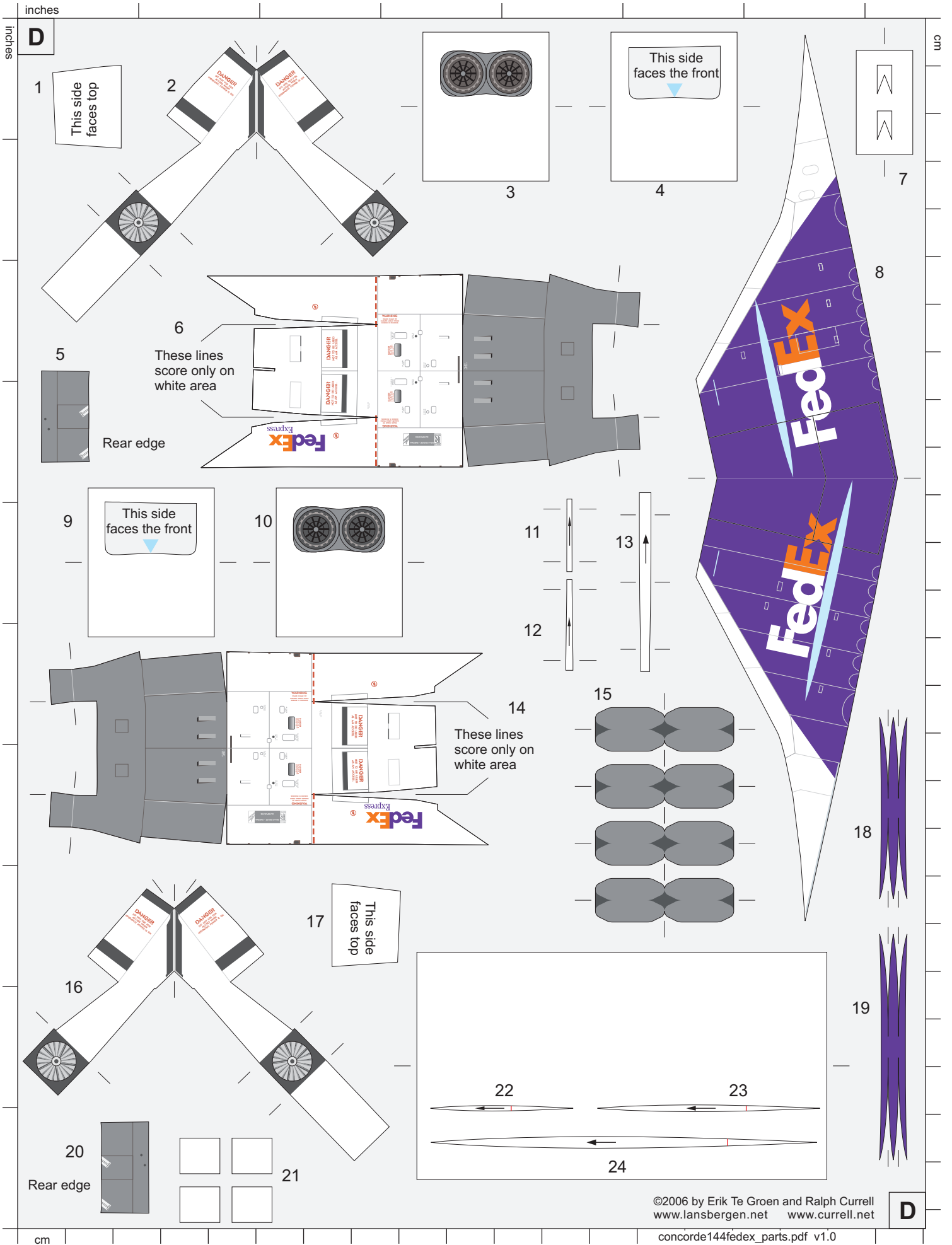

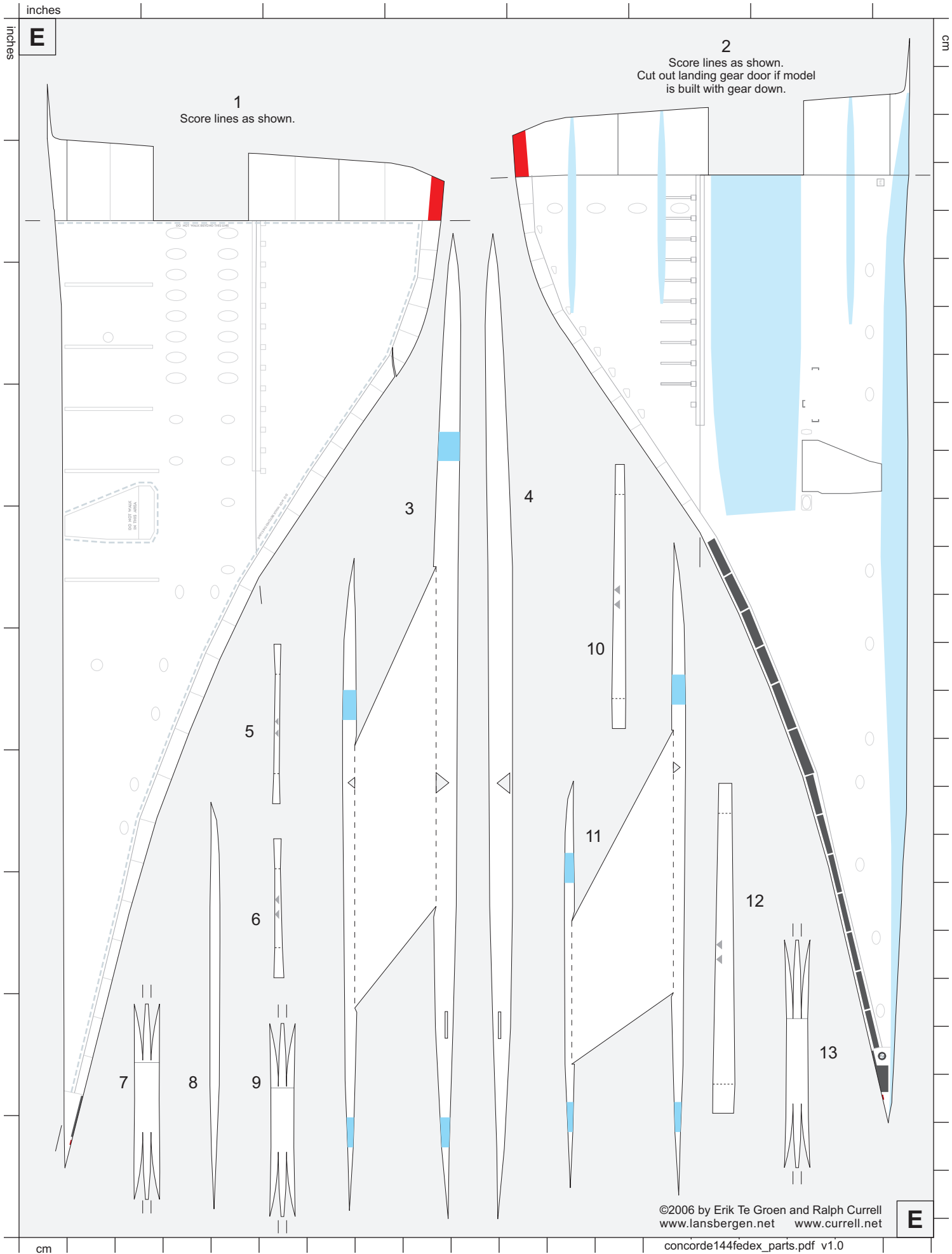

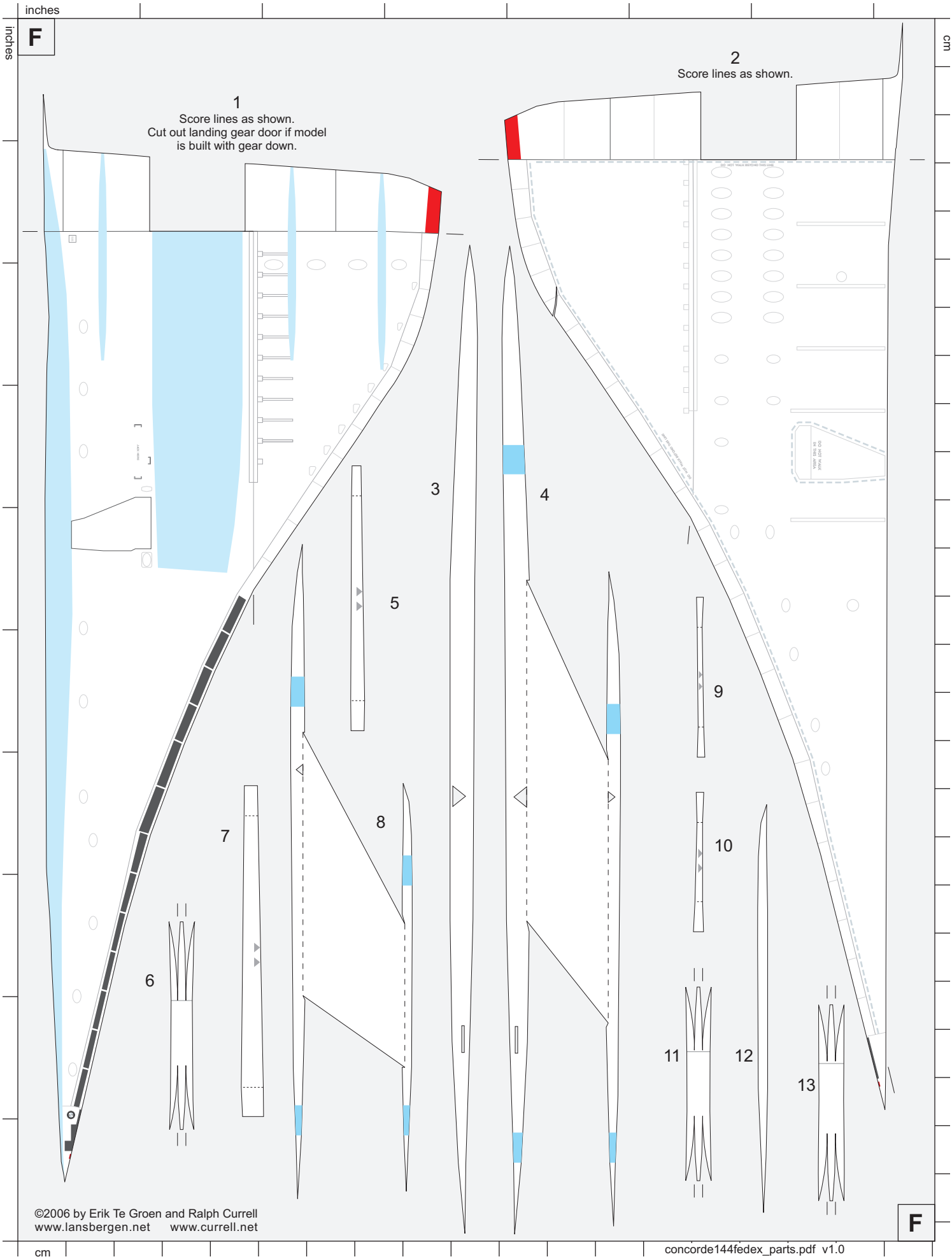

inches

inches

G

This page is required only if building the model with landing gear down.

cm

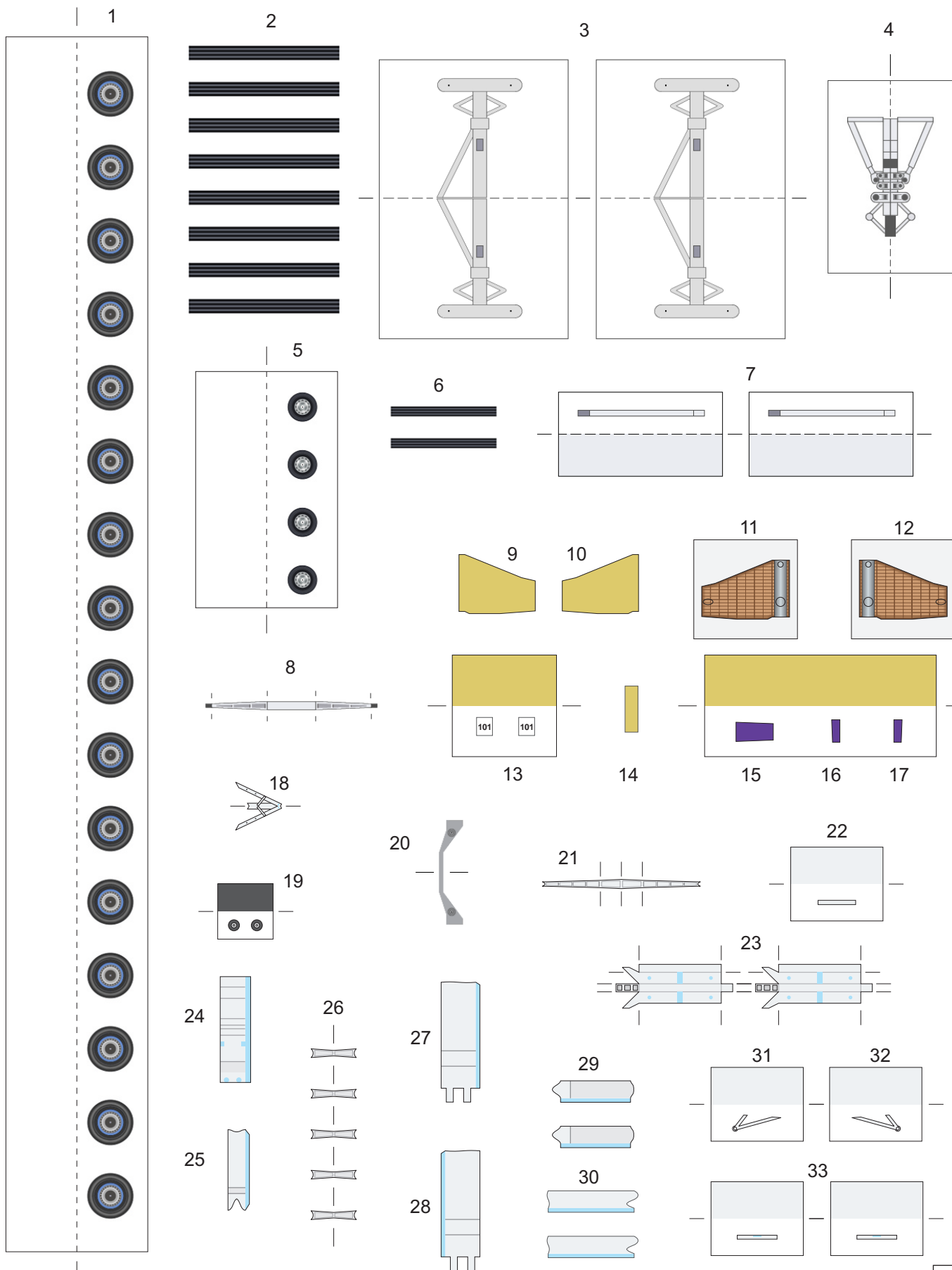

G

cm